

Represented by



**ILLING**<sup>TM</sup>  
P A C K A G I N G

## Product Specification Sheet

Illing Part#

3626TE/ABO

# 63 MM WHITE PP CAP TE/ABO W/ BAREX LINER

**Part #: 3626TE/ABO**

Size:	63 MM
Color:	White
Material:	PP
Style:	Plastic Cap
Additional Info:	Tamper Evident/ABO, With Barex Liner
Case Pack:	500 each
Pallet Pack:	10,000 each

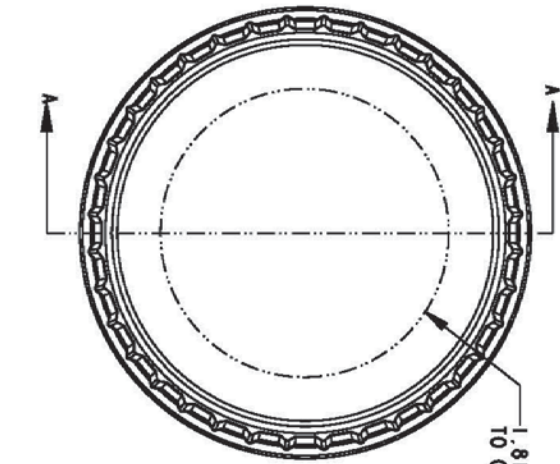

1.81 DIA FOR PRINTING TO CUSTOMER REQUIREMENTS **B**

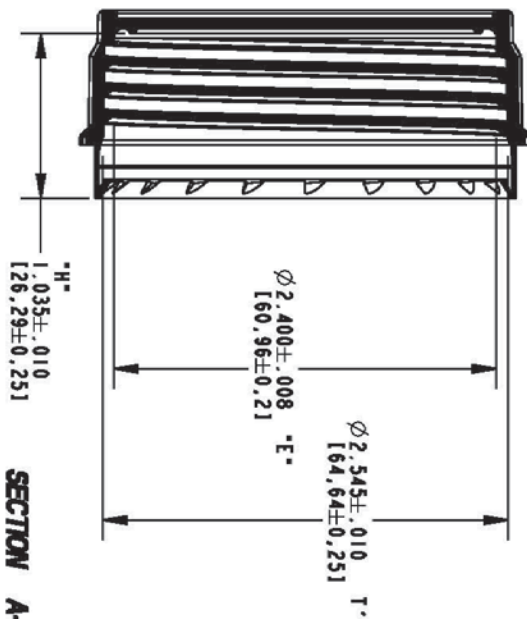

**SECTION AA**

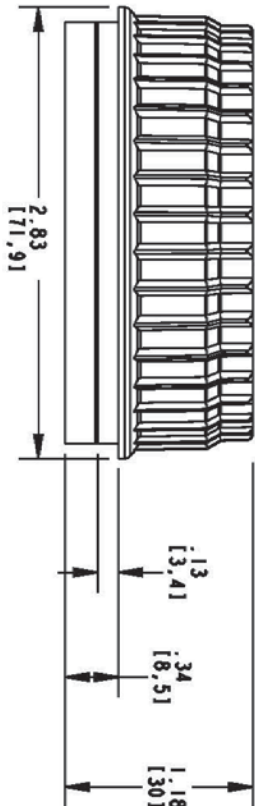

**NOTE**  
 EFFECTIVE "H" DIMENSION IS DETERMINED BY THE TYPE OF LINER USED IN THE CLOSURE. OVERALL "H" WILL BE LESS THAN SHOWN ONCE THE LINER IS APPLIED.  
 REFER TO DRAWING MOT68-002-A FOR BOTTLE OPENING DETAILS.  
 PRO/E  
 RECOMMENDED TORQUE 50 - 55 IN-LBS

BREAK ALL SHARP EDGES WITH 1/64" RADIUS SPECIFIED UNLESS OTHERWISE SPECIFIED	DATE	DRAWN BY
THE FOLLOWING TOLERANCES APPLY UNLESS OTHERWISE SPECIFIED:	6-DEC-01	RDR
ANGLES	±1/4°	CHECKED
HUNDREDTH	±.015	SCALE
THOUSANDTH	±.005 IN/IN	NTS
		APPROVED

THIS DOCUMENT AND ITS CONTENTS DISCLOSE INFORMATION THAT IS PROPRIETARY TO BIEE PACKAGING SYSTEMS, WHETHER POSSESSION OR RECEIPT OF THIS DOCUMENT, OR ITS CONTENTS, COMES WITH OR WITHOUT WRITTEN AUTHORIZATION FROM BIEE PACKAGING SYSTEMS.		DATE	BY
CHANGE NUMBER	CHANGE	21-APR-04	RDR
A	ADDED TORQUE SPECIFICATION VALUE 50 - 55 IN-LBS	22-AUG-03	RDR
B	ADDED PRINTING NOTE		

<b>Rialbe</b> Corporation — Auburn, Indiana	
DETAIL NAME	SC 63mm TAMPER EVIDENT CLOSURE
TOOL ASS'Y NAME	
PRODUCT	SC63TE
DRAWING NUMBER	28001720
FOR	IN
MATERIAL	POLYPRO
TEMPER	
TOOL ASS'Y NUMBER	DETAIL NUMBER
	SC63TE



Agricultural Products Division	Product: Rieke 63mm anti back-off Tamper evident, foam liner	Spec. Number: 2065109
	Product Code:	Replaces: 7/15/03
Packaging Component Specification	Issue Date: 9/14/05	Rev. # 1 Sheet 1 of 2

Component: CLOSURE, PLASTIC

Description: **Eazy Break**, plastic, tamper evident, anti back-off closure, with chemical resistant foam liner.

Style: 63mm with 445M style continuous thread, injection molded

Material: Polypropylene

Color: White,

Size: 63mm/445

Liner & Adhesive: Tri-Seal, Tri-Foil:  
 - .050" F217, .00035" Al Foil, .002" White LDPE, .0005" Clear Polyester  
 - 25 lbs/cu ft density  
 -or-  
 Barrex:  
 Expanded Polyolefin foam, FDA compliant w/21CFR177.1210  
 - 0.001" C25 Barrier Layer (Sealig Co)  
 - 0.002" Barrex Film  
 - Thickness: .02"-.05"  
 - Density: 25-28 lbs/cu. ft

Dimensions: Thread Pitch: 6 TPI "T" - 2.545" +/- 0.010"  
 Outside Dia.: 2.83" +/- 0.010" "E" - 2.400" +/- 0.010"  
 Overall Height: 1.18" +/- 0.010" "H" - 1.035" +/- 0.010"

Weight: 20 Grams +/-1

Embossing: NA

Reference: Drawing attached – RIEKE SC 63TE drawing#28001720 (Part #: SC-63TE-101?? Eazy Break)

Packing: Poly wrapped in corrugated cartons on pallets protected from dirt and dust.

Special Instructions: → \*Cap Must be properly torqued at <sup>50-</sup> 55 lbs/in to seal effectively.

Revision: #1 – 9/14/05: Changed to Rieke Eazy break TE band. Band goes from 15 retention points to 12.

SIGNATURE ON FILE

ORIGINATOR: \_\_\_\_\_ QUALITY ASSURANCE: \_\_\_\_\_